







Wrapping manual



YOU WILL NEED

-  Fiber cloth *
-  Johnsons Baby or Fairy shampoo
-  Degreaser/anti-silicone
-  Squeegee *
-  Sprayer
-  Hot air gun
-  Knife *
- * included in the kit

Preparation for installation

Graphics should be applied in a warm room, at room temperature. Unroll the kit and let it warm for about 1 hour on a flat surface before applying the graphics.

IMPORTANT! Well-prepare the surface of your technique. It is necessary to pre-wash all plastic from dust and dirt. The last stage of preparation for drawing graphics is degreasing the working surface with a degreaser or anti-silicone and fiber cloths (the latter are included in the kit). Without these conditions, a high level of decals adhesion and graphics durability are not guaranteed.

Contact with primer, gasoline, kerosene, oil, thinner, alcohol and other chemicals on the film is guaranteed to destroy and render the sticker unusable. Don't let this happen!

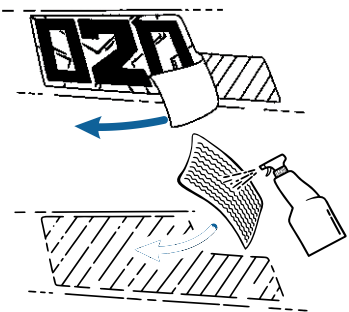
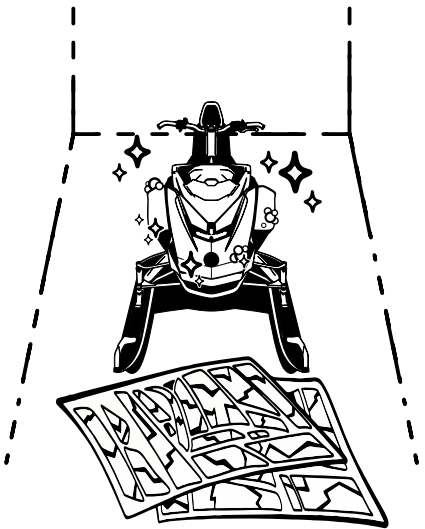

Life hacks and tips

Some snowmobiles have air filter protectors. When you warm up the stickers, we recommend dismantling air filter protectors, as exposure to hot air from a hot air gun can melt them.

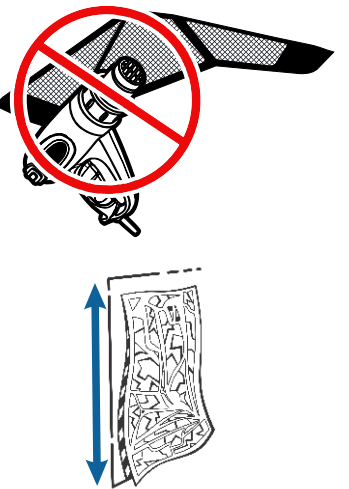

Sheets with kit elements can be conveniently hung on vertical surfaces. On the wall, gate, closet. This makes it easier to find the decals you needed to install.



Features of pasting by templates

Our stickers are made using templates. This is cutting out all the plastic parts of the technique that will be covered by stickers. The plastic is volumetric and the stickers are flat. It is impossible to perfectly account for the shape of a flat piece that is intended to be applied to fluffy plastic. This creates a number of difficulties during pasting. Some parts need to be stretched in place or trimmed for best coverage.

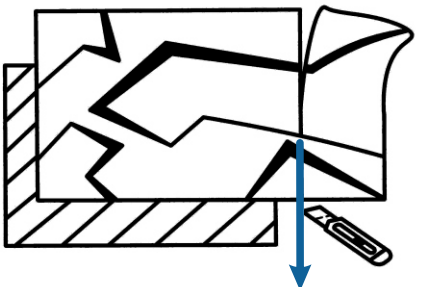
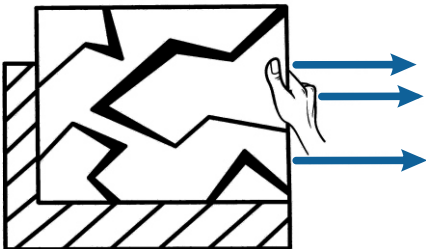

Also there is a problem in stamping plastic parts at the factories of technique. It does not allow all parts to be produced 100% the same. Temperature, curls during transport and even pressure can affect the shape of plastic parts. And the change in the shape of the volumetric part significantly affects the final coating with flat stickers.

We are constantly improving the templates and even use a 3D scanner to create them with a minimum error of 0.1 mm per 1 meter. Nevertheless, some elements have inaccuracies in size. More often this is characteristic of kits for techniques that are over 6 years old, since it is less common. We often do not have the opportunity to improve the templates due to the fact that for their creation and adjustment we need physical access to the technique and several fittings of parts.

These properties and features affect the final view of technique. Therefore, some decals need to be stretched or trimmed in place. But do not think that templates have only drawbacks. Thanks to the large number of small parts, we can optimize the material costs of our kits. This makes stickers cheaper, more affordable, and more versatile. You can order our kit from the other end of the world and be sure that the application will not be dreary and difficult, the kit will be suitable for your technique and will have a high coverage density, and you will be satisfied with the result.

Application recommendations

HOW TO START

We recommend starting application with the front center section of the technique and then applying the details to the sides of it. This is necessary to best match the pattern and maintain symmetry.

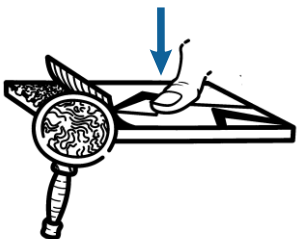
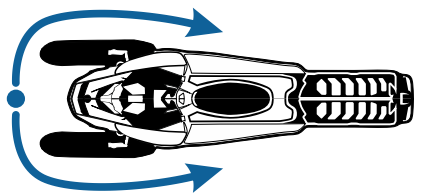

INSTALLATION ON TEXTURED PLASTIC

When you apply decals on non-glossy (textured) surfaces, we recommend NOT to use soapy water. Stickers to such surfaces do not adhere immediately during the fitting to the place, so they can be positioned without using a soap solution. During the heating of parts on such plastic, you need to pay attention to the tight fit of the stickers to the plastic.

Immediately after moderate heating with a hot air gun of a small section of the sticker, you need to iron it and press it firmly against the plastic with your fingers. Up to the manifestation of the texture of the plastic on the surface of the stickers themselves.

ROUNDED DECALS

When applied to rounded surfaces and parts, it is necessary to heat the film with a hot air gun and pull it over the roundness. Next, you need to smoothly lower it onto the part so that the element envelops the plastic. For the possibility of further repositioning of the sticker, it is better to moisten the surface with soapy water. And after application, the moisture must be completely expelled from under the sticker, otherwise the water will evaporate during warming up and leave bubbles between the film and the plastic.

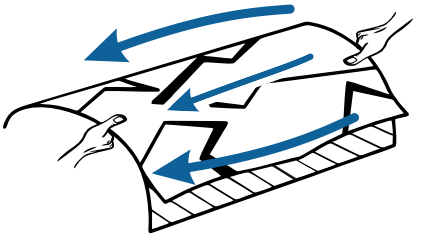

CRUMPLED DECALS

If the film was crumpled during application, slightly warm it up with a construction hot air gun. This will help smooth out the bumps and get the decal back in normal shape.



Decaling process

- 1

Spray some soapy water (recipe: 3 drops of Johnsons Baby or Fairy shampoo in 1 liter of water) onto the surface to be pasted and the adhesive side of the sticker (if this part is not for textured plastic)
- 2

Position the decal on the plane as precisely as possible.
- 3

Roll the element with a squeegee (it is included in the kit. It is necessary to squeeze the moisture out from under the film as much as possible).
- 4

An hour after application, it is necessary to warm up all the stickers with a hot air gun at a temperature of 80-90°C.
- 5

Next day after application, carry out the final heating of the entire set so that the adhesion of the film is maximum (at a temperature of 80-90°C).

